





MASCOTTE TECHNICAL RIDER

Naningo AG
Theaterstrasse 10
8001 Zürich
T +41 44 260 15 80
F +41 44 260 15 84
info@mascotte.ch

LEGENDE:

-  122x Sitzplätze
-  1x Vorhang
-  4x SGM Giotto Wash CMY
-  6x SGM Giotto Spot 400 CMY
-  6x Briteq BT-W19L10 Zoom
-  10x Briteq Pro Beamer
-  2x SGM 100w LED Moving Head
-  2x Profiler 1000w
-  2x Fresnel 500w
-  4x IRGBWS Column Lights
-  1x Rollleinwand 3.4m x 3.4m
-  1x Vivitek Beamer 3000lumen
-  3x 32 amp 480V Stromverteiler
-  4x 230V Dreifachsteckdose
-  16x Barhocker
-  13x Stehtische
-  2x mobile Kühlschränke
-  3x mobile Barelemente

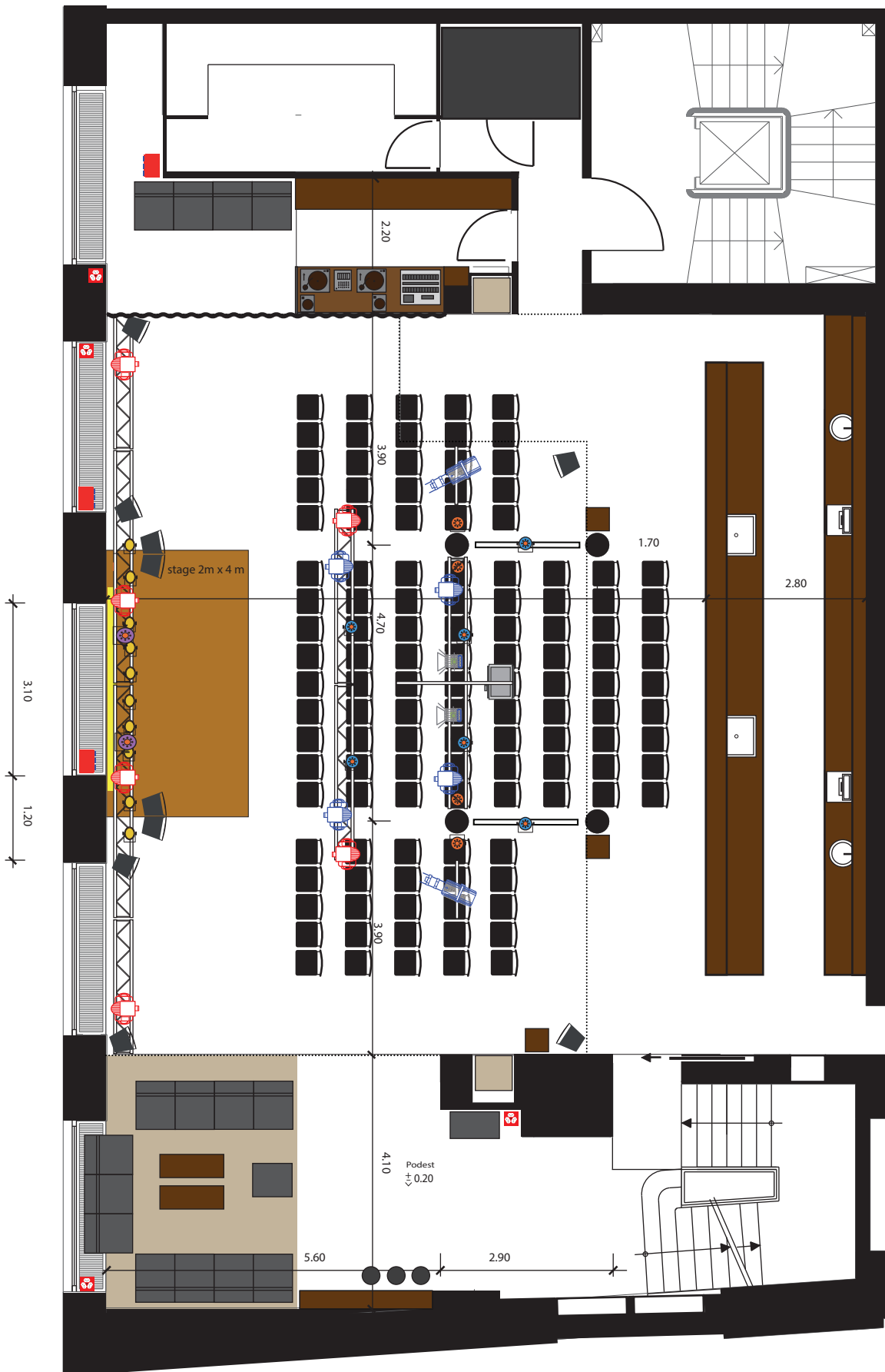

LAYOUT MAINFLOOR - SEATED VENUE
(100 % view to screen)