

MASCOTTE TECHNICAL RIDER

Naningo AG
Theaterstrasse 10
8001 Zürich
T +41 44 260 15 80
F +41 44 260 15 84
info@mascotte.ch

LEGENDE:

-  150x Sitzplätze
-  1x Vorhang
-  1x Stagebox with 2x CEE32
6x Floordimmerchannel etc.
-  7x 230V Dreifachsteckdose
-  16x Barhocker
-  13x Stehtische
-  2x mobile Kühlschränke
-  3x mobile Barelemente
-  6x dtsMAX
-  4x SGMGiottoSpot400CMY
-  8x Briteq BT-W19L10 ZOOM
-  4x SGM Idea LED 100
-  2x SGM Idea LED 300
-  12x Briteq Pro Beamer
-  2x UniqueHazer
-  2x ETC S4 25°-50°, 750W
-  2x Fresnel 1000W
-  2x Briteq COB Blinder 2x100w
-  2x 4x400w Halogen Blinder
-  20x Micro Beamer RGBW
-  4x SGM Flasher 1500W
-  1x SGM XC5
-  1x Hitachi LP-WU6600 /
6000 ANSI Lumen / Laser / WUXGA
-  3x NEC M350XS
3500 ANSI Lumen / XGA
-  1x 90cm Mirror Ball
-  2x 50cm Mirror Ball
-  1x Motorscreen
3.4m x 3.4m
-  1x Swirl Fan XL
-  3x Videoprojection
a totalof 20 m²

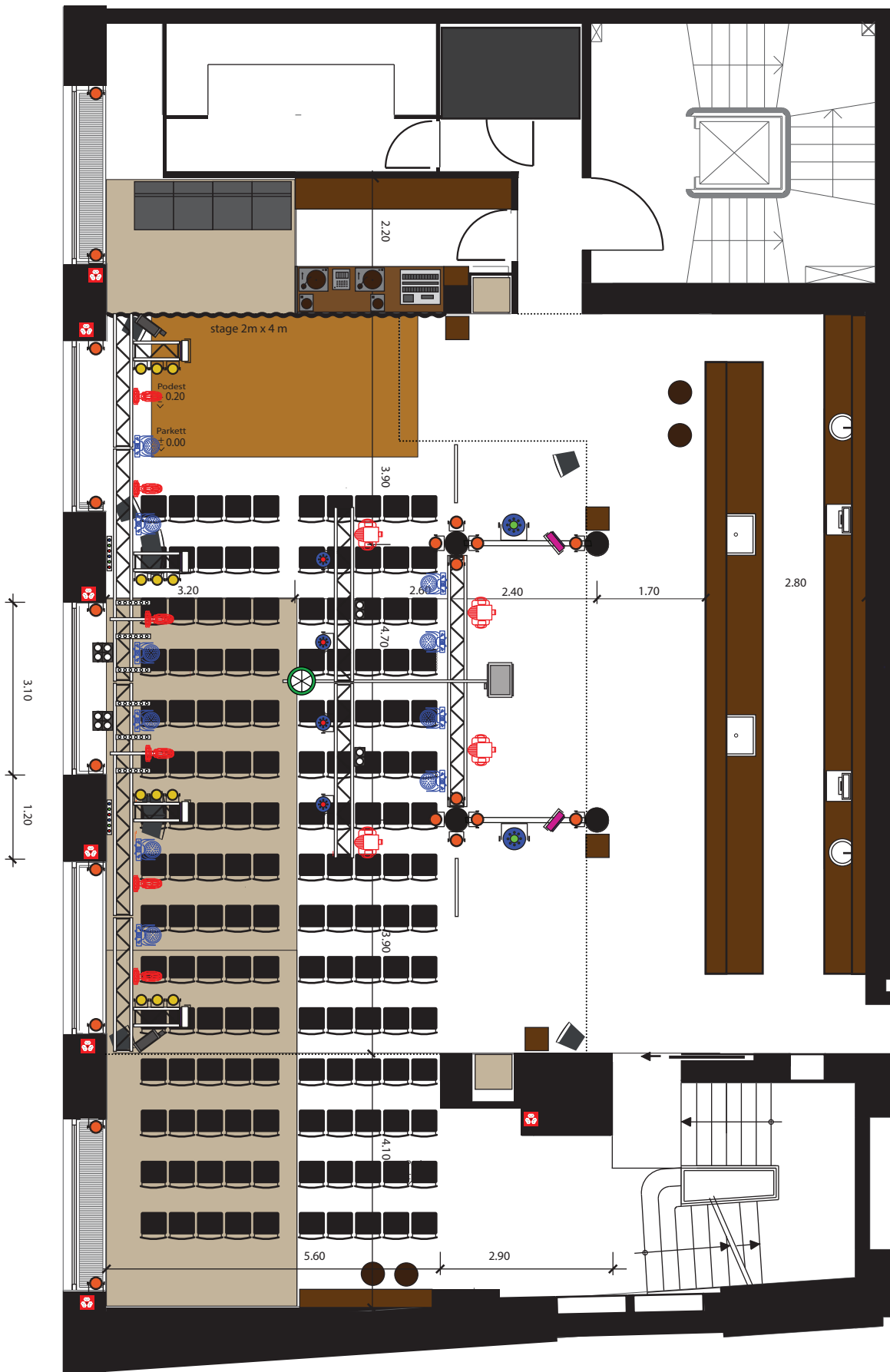

LAYOUT MAINFLOOR - SEATED VENUE STAGE LEFT