

MASCOTTE TECHNICAL RIDER

Naningo AG
Theaterstrasse 10
8001 Zürich
T +41 44 260 15 80
F +41 44 260 15 84
info@mascotte.ch

LEGENDE:

-  1x Yamaha M7CL 48
Rocknet Digital Stagebox
-  1x Jands Vista i3 Lightdesk
-  6x KV2 WHD 2.15
-  2x KV2 ES 1.0
-  6x KV2 ESD 1.2
-  6x KV2 ESM 1.2
-  1x Kling&Freitag 115 Drumfill
1x Kling&Freitag 1215 Drumfill
-  1x Stagebox with 2x CEE32
6x Floordimmerchannel etc.
-  6x dtsMAX
-  4x SGMGiottoSpot400CMY
-  8x Briteq BT-W19L10 ZOOM
-  4x SGM Idea LED 100
-  2x SGM Idea LED 300
-  12x Briteq Pro Beamer
-  2x UniqueHazer
-  2x ETC S4 25°-50°, 750W
-  2x Fresnel 1000W
-  6x Briteq LED Blinder White
-  2x Briteq LED Pixelbar RGB
-  2x Briteq COB Blinder 2x100w
-  2x 4x400w Halogen Blinder
-  20x Micro Beamer RGBW
-  4x SGM Flasher 1500W
-  1x SGM XC5
- 1x Hitachi LP-WU6600 / 6000
ANSI Lumen / Laser / WUXGA
- 3x NEC M350XS 3500
ANSI Lumen / XGA
- 1x 90cm Mirror Ball
- 2x 50cm Mirror Ball
- 1x Motorscreen
3.4 m x 3.4 m
- 1x Swirl Fan XL
- 4x Co2 Booster
- 3x Videoprojection
a total of 20 m²

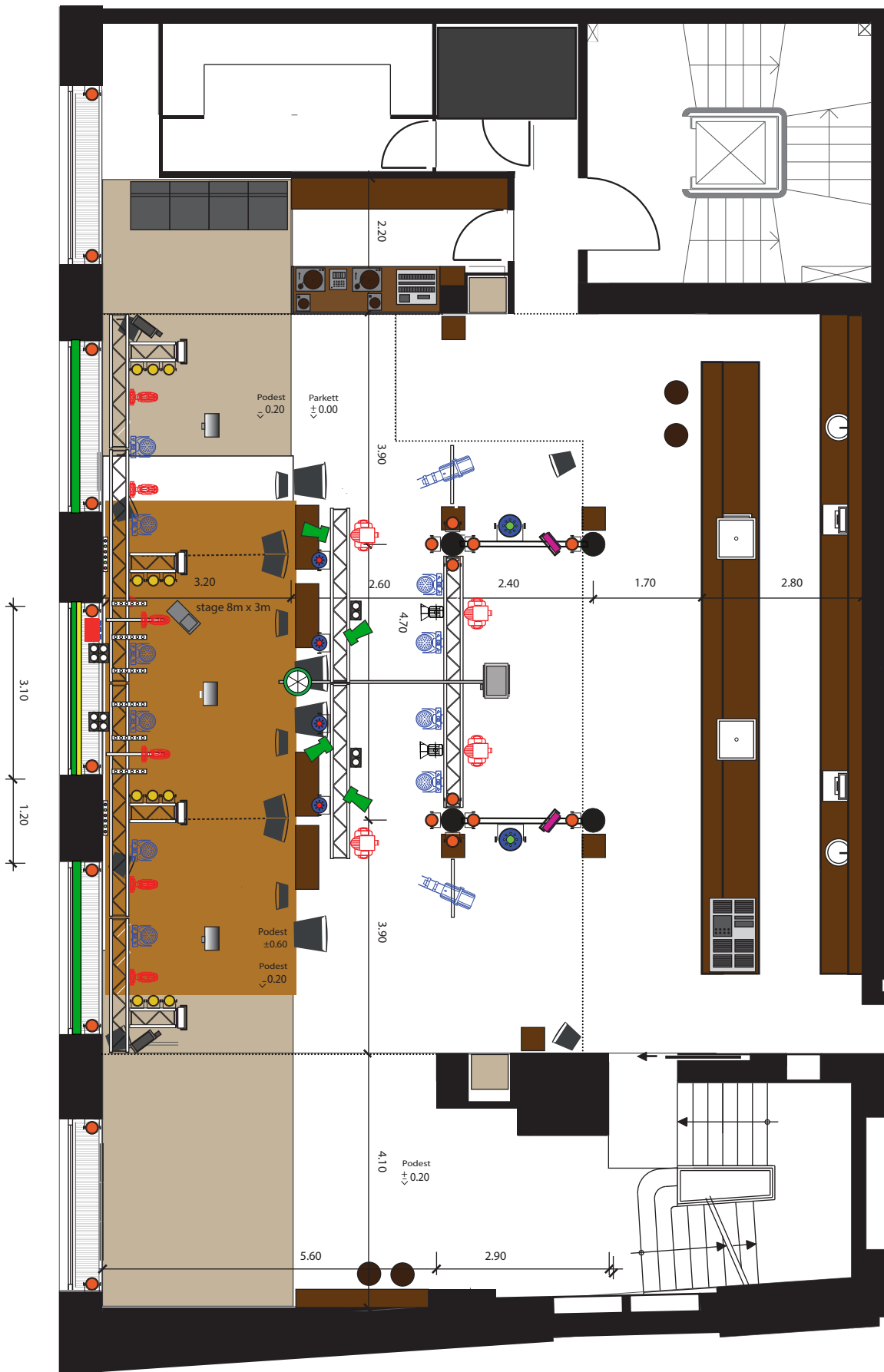

LAYOUT MAINFLOOR - CONCERT